

**VIEWPORT 1**

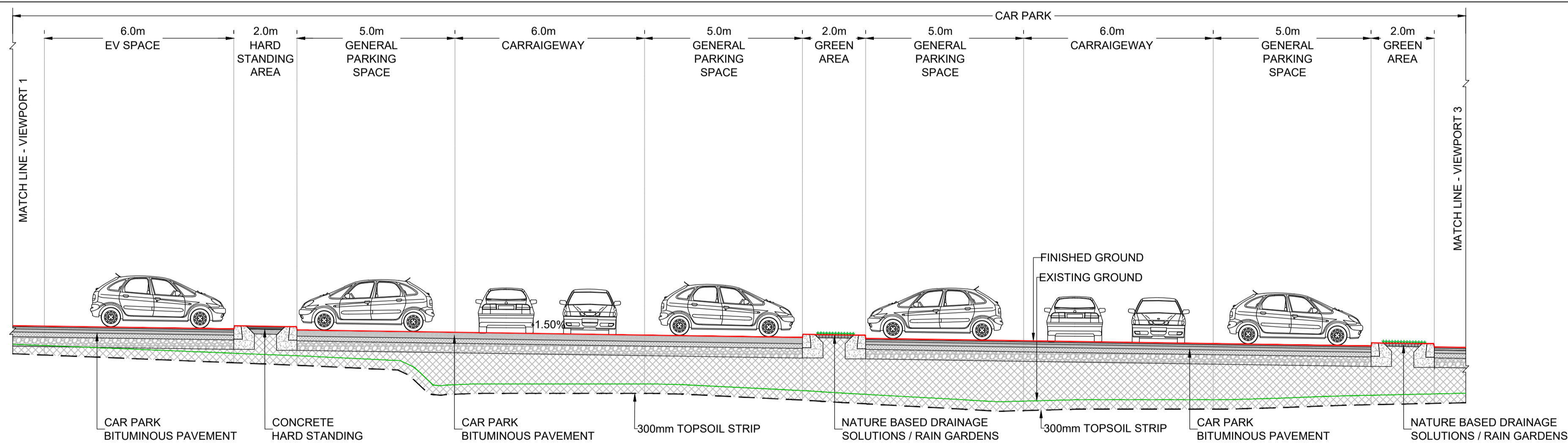

**VIEWPORT 2**

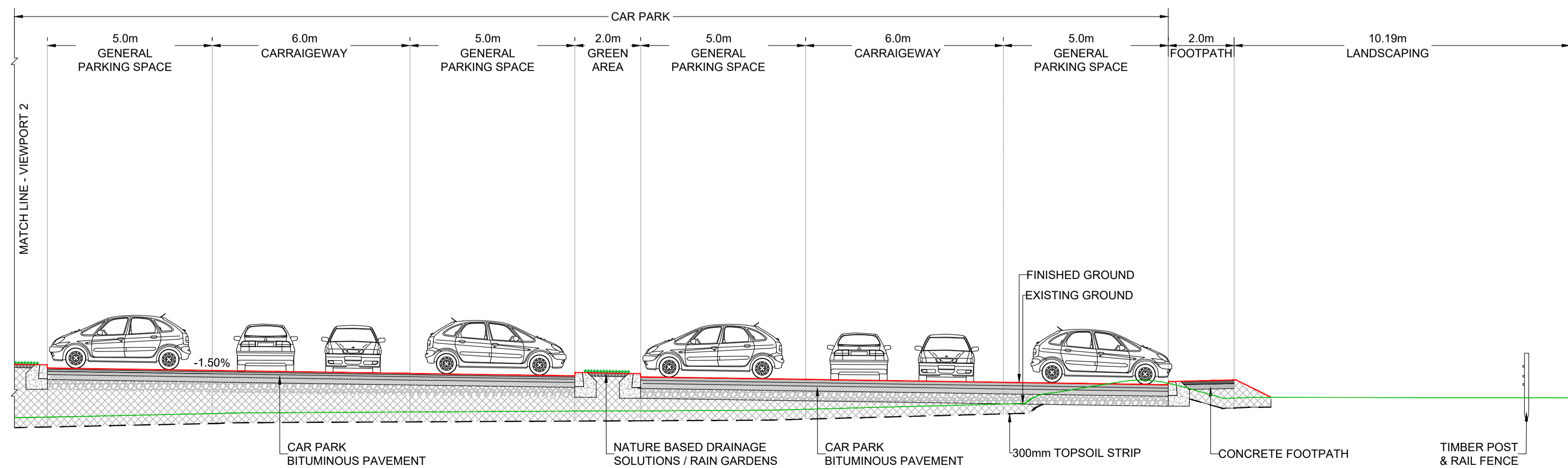

**VIEWPORT 3**

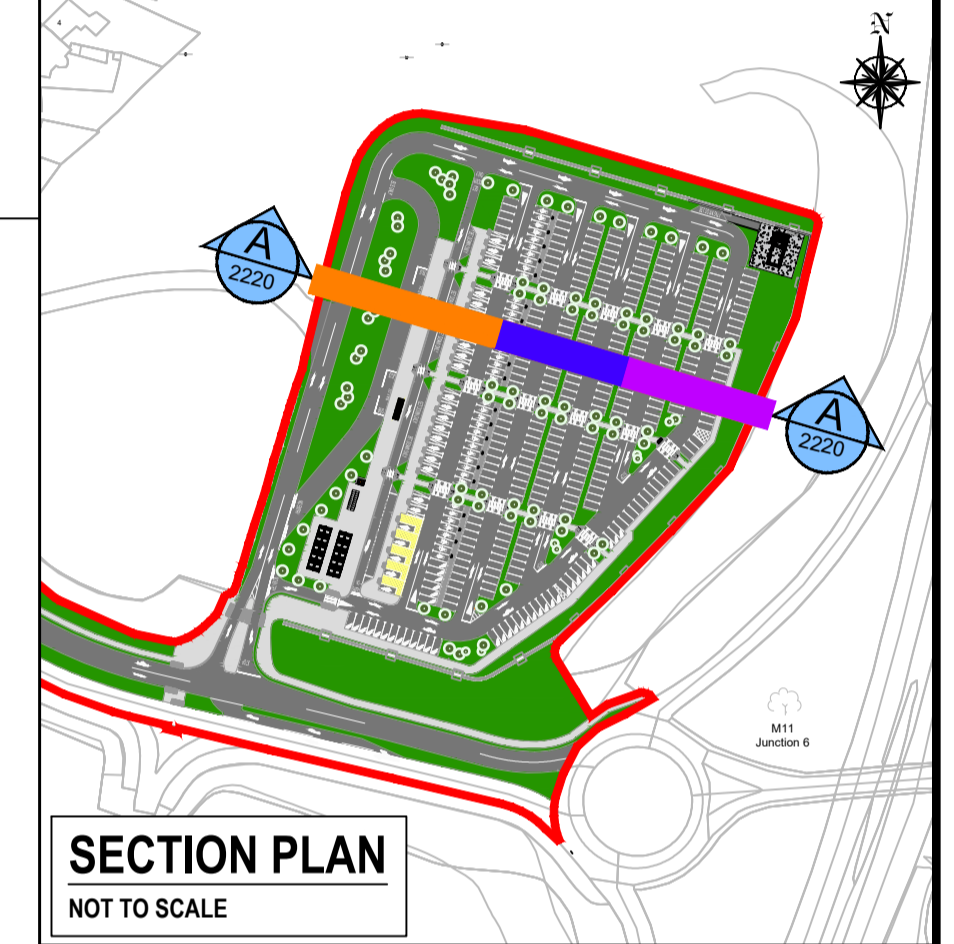

Rev	Description	Drawn	Checked	Date
P03	ISSUED FOR PLANNING	SM	BD	28/07/23

**Clifton Scannell Emerson Associates**  
 Consulting Engineers,  
 3rd Floor The Highline,  
 Bakers Point, Pottery Road,  
 Dun Laoghaire, Co. Dublin,  
 Ireland, A96 KW29  
 T: +353 1 288 5006  
 F: +353 1 283 3466  
 E: info@csea.ie  
 W: www.csea.ie

Client: **WICKLOW COUNTY COUNCIL**  
 Project: **FASSAROE PARK AND RIDE FACILITY**  
 Dwg. Title: **TYPICAL CROSS SECTION SECTION A-A**  
 Drawn By: **SM** Date: **JAN 2023**  
 Checked By: **IR** Scale: **N.T.S@ A1** **20\_008N**  
 Project Code: **20\_008N - CSE - GEN - XX - DR - C - 2220**

Status Code: **S2** Part VIII Approval  
 Project Status: **P03** FOR PLANNING